

XAL-4VF

DATA SHEET

Fixed Outside Louvre Flange Frame, Vertical Blades

DIMENSIONS (mm)

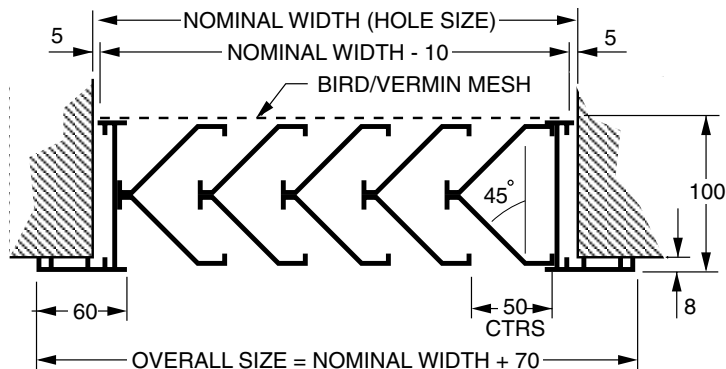

TYPICAL HORIZONTAL SECTION

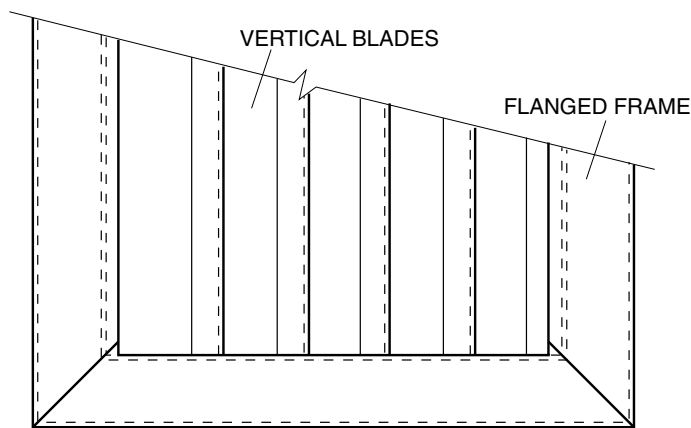

FRONT ELEVATION

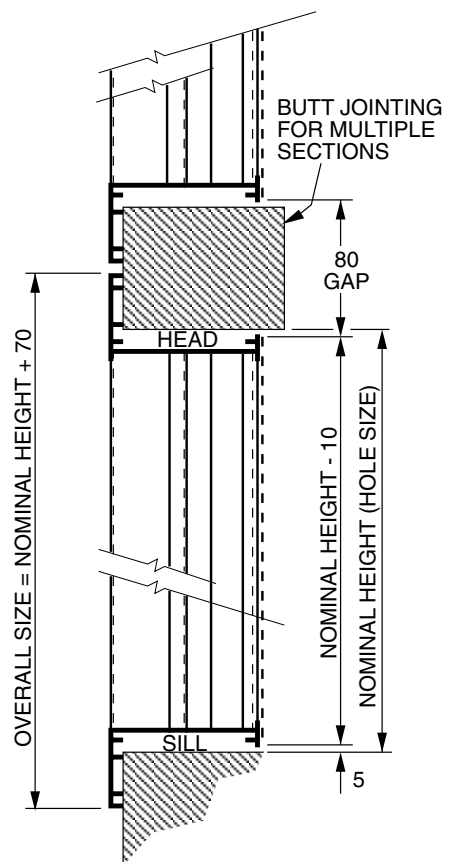

TYPICAL VERTICAL SECTION

STANDARD CONSTRUCTION

BLADES/FRAME:	6063-T5 extruded aluminium
MESH - Optional:	Expanded aluminium
FINISH - Standard:	Mill or powder coat (standard colours)
MINIMUM SIZE:	300 mm width x 300 mm height
MAXIMUM SECTION SIZE:	2000 mm width x 2000 mm height
SIZE AVAILABILITY:	Width to order; 300 mm and over Height in 100 mm increments Channel frame version (XAL-4VC) also available.
SELECTION DATA:	Refer overleaf

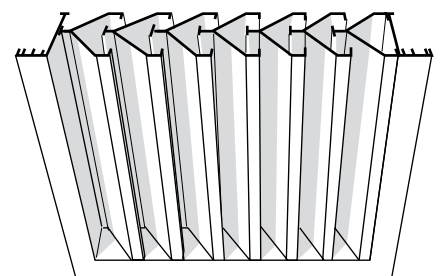

NOTE

The manufacturer reserves the right to make changes in specifications at any time without notice or obligation. Certified dimensions available on request.

SELECTION DATA

Effective Area (m²)

		NOMINAL WIDTH (m)																	
		0.3	0.4	0.5	0.6	0.7	0.8	0.9	1.0	1.1	1.2	1.3	1.4	1.5	1.6	1.7	1.8	1.9	2.0
NOMINAL HEIGHT (m)	0.3	0.02	0.04	0.06	0.08	0.10	0.12	0.14	0.17	0.18	0.20	0.23	0.24	0.26	0.29	0.30	0.32	0.33	0.36
	0.4	0.03	0.07	0.10	0.12	0.15	0.17	0.20	0.23	0.25	0.28	0.31	0.33	0.36	0.39	0.42	0.44	0.47	0.50
	0.5	0.04	0.08	0.12	0.15	0.18	0.22	0.25	0.29	0.32	0.36	0.39	0.43	0.46	0.50	0.53	0.57	0.60	0.64
	0.6	0.05	0.09	0.14	0.19	0.22	0.27	0.31	0.35	0.39	0.43	0.48	0.52	0.56	0.61	0.65	0.69	0.74	0.78
	0.7	0.06	0.11	0.16	0.21	0.26	0.31	0.36	0.41	0.46	0.51	0.56	0.61	0.66	0.72	0.77	0.82	0.87	0.92
	0.8	0.08	0.14	0.19	0.25	0.30	0.36	0.42	0.47	0.53	0.59	0.65	0.71	0.77	0.83	0.88	0.94	1.00	1.06
	0.9	0.09	0.15	0.22	0.28	0.35	0.41	0.48	0.54	0.60	0.67	0.73	0.80	0.87	0.94	1.00	1.07	1.14	1.20
	1.0	0.10	0.17	0.24	0.31	0.38	0.46	0.53	0.60	0.67	0.75	0.82	0.90	0.97	1.04	1.12	1.19	1.27	1.34
	1.1	0.11	0.19	0.27	0.35	0.43	0.51	0.59	0.67	0.75	0.83	0.91	0.99	1.07	1.15	1.23	1.31	1.39	1.48
	1.2	0.12	0.21	0.30	0.39	0.48	0.57	0.66	0.75	0.83	0.90	0.98	1.06	1.14	1.22	1.30	1.38	1.46	1.62
	1.3	0.13	0.23	0.32	0.42	0.52	0.62	0.71	0.81	0.91	1.00	1.10	1.19	1.29	1.38	1.47	1.57	1.66	1.76
	1.4	0.14	0.25	0.35	0.46	0.56	0.67	0.78	0.88	0.99	1.09	1.19	1.26	1.39	1.50	1.59	1.70	1.79	1.90
	1.5	0.15	0.27	0.38	0.50	0.61	0.73	0.84	0.96	1.07	1.18	1.29	1.39	1.46	1.61	1.72	1.83	1.93	2.04
	1.6	0.16	0.28	0.41	0.53	0.66	0.78	0.90	1.03	1.15	1.26	1.38	1.49	1.61	1.68	1.83	1.95	2.06	2.18
	1.7	0.17	0.30	0.44	0.57	0.70	0.83	0.97	1.10	1.23	1.35	1.47	1.59	1.71	1.84	1.90	2.08	2.20	2.32
	1.8	0.18	0.32	0.47	0.61	0.76	0.90	1.04	1.19	1.33	1.46	1.58	1.71	1.83	1.96	2.09	2.16	2.34	2.46
1.9	0.20	0.35	0.50	0.65	0.80	0.94	1.09	1.24	1.39	1.52	1.66	1.79	1.93	2.06	2.20	2.33	2.41	2.60	
2.0	0.21	0.37	0.53	0.69	0.85	1.01	1.17	1.33	1.47	1.61	1.75	1.89	2.03	2.17	2.31	2.45	2.60	2.70	

Note: Above table applies to vertical blade louvres only.

Pressure vs. Velocity Characteristics

Intake Pressure (pascals)	2	4	7.5	12	17	23	30	38	46	57	67	79	92
Velocity(m/s) over Effective Area	1.0	1.5	2.0	2.5	3.0	3.5	4.0	4.5	5.0	5.5	6.0	6.5	7.0
Exhaust Pressure (pascals)	1.25	2.7	5.0	7.7	11.2	15.4	20	25	31	38	45	53	61

SELECTION PROCEDURE - Example

Aim: To identify an outdoor louvre for an intake duty of 0.60 m³/s at a pressure requirement of 38 Pa.

- From **Pressure vs. Velocity** Table, velocity for 38 Pa intake pressure = 4.5 m/s .
- Effective Area = $\frac{\text{m}^3/\text{s}}{\text{Velocity}} = \frac{0.6}{4.5} = 0.133 \text{ m}^2$
- From **Effective Area** Table (see shading), suitable nominal sizes are:
 - 0.9 m width x 0.3 m height
 - 0.5 m width x 0.6 m height
 - 0.4 m width x 0.8 m height

Available from



temperzone limited

Head Office :
 38 Tidal Rd, Mangere South, Manukau 2022
 Private Bag 93303, Otahuhu, Manukau 1640
 Email: sales@temperzone.co.nz
 Website: www.temperzone.biz

AUCKLAND: Ph. 0-9-279 5250, Fax 0-9-275 5637
 WELLINGTON: Ph. 0-4-569 3262, Fax 0-4-566 6249
 CHRISTCHURCH: Ph. 0-3-379 3216, Fax 0-3-379 5956